



PRS Mobile Installation and Configuration

PRS Mobile is a companion app that enables remote users to access some of the functionality of the PRS Desktop application. It is designed to run on iOS and Android tablets and mobile phones, and can be installed from the relevant app stores on each platform.

The following pages detail the installation steps to install and configure the app on staff or company devices. The installation process is in two stages:

- Physical App Installation
- In-App Configuration

The following sections detail the steps required for each stage.

Physical Installation – Android Devices

To install PRS Mobile on Android phones and tablets (Samsung, Opposition's, Pixel, etc), open the Google Play Store App on the user's device, search for "PRS Site", and select the correct app from the list.

Press Install, and then Open to launch the App.

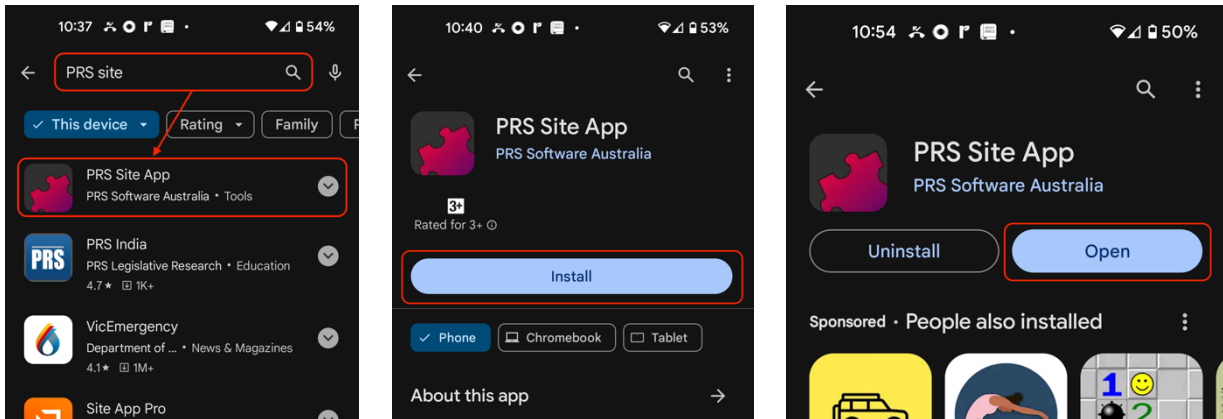

On opening the App for the first time, you will be asked to enable some permissions for PRS Mobile to operate correctly. Tap the appropriate button to allow this:

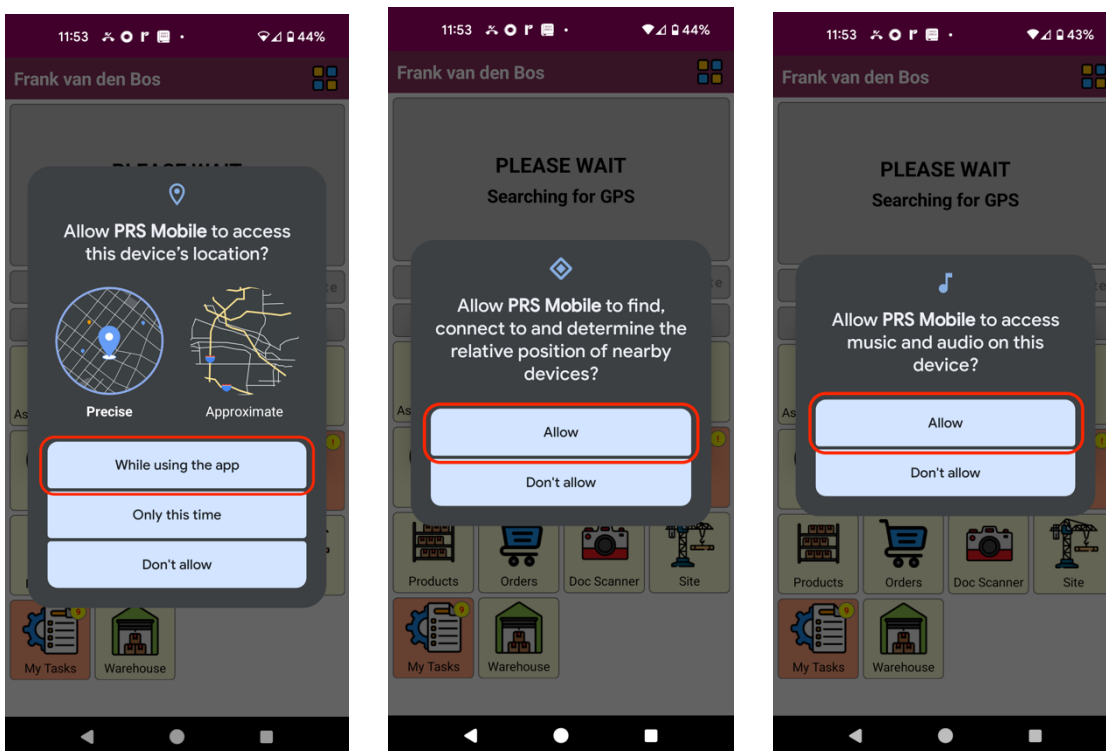

Physical Installation - iOS Devices

To install PRS Mobile on iOS phones and tablets App Store on the user's device, and search for "PRS Site".

Press the Cloud Icon to install the software, and then "Open" to launch the App.

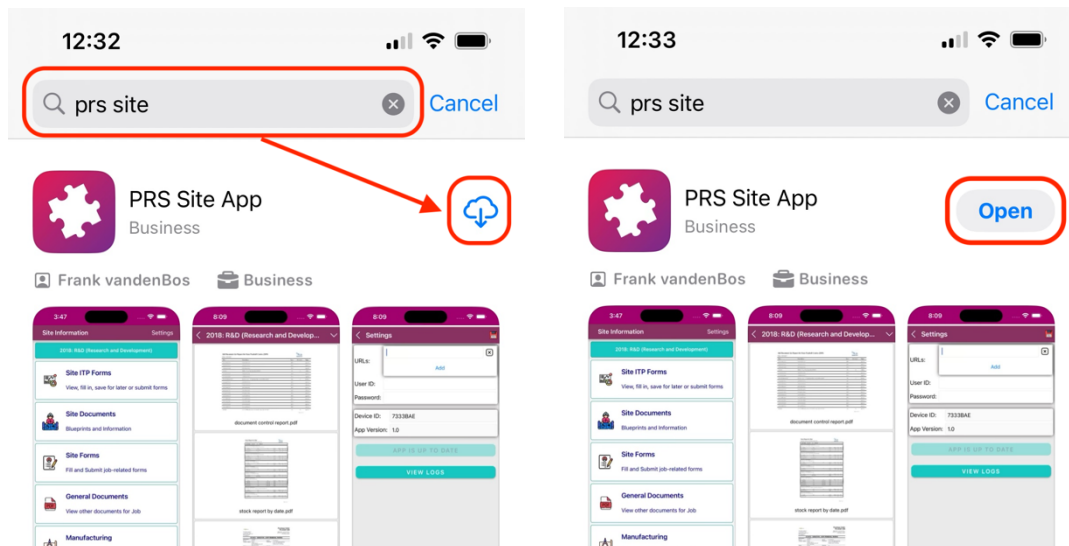

On opening the App for the first time, you will be asked to enable some permissions for PRS Mobile to operate correctly. Tap the appropriate button to allow this:

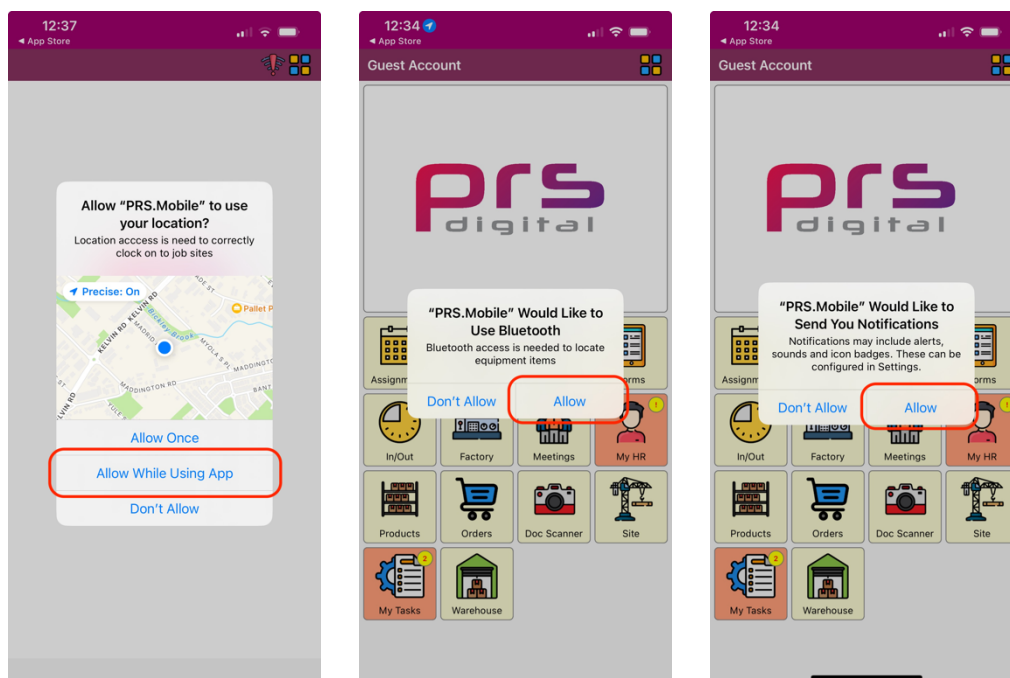

Post-Installation Configuration

Once the app is running, you can proceed to configure the Application by clicking the Menu button at the top-right of the PRS Mobile main screen:

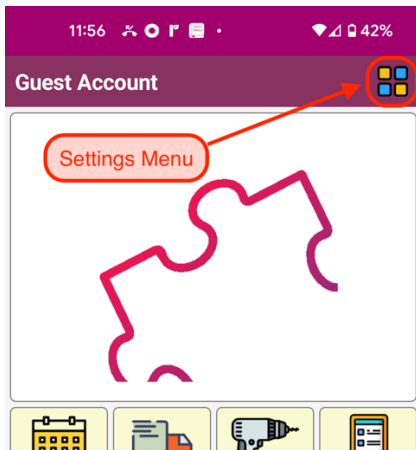

This will display the App Settings screen. Replace the default settings with the information specific to your company and the user who will operate this device:

